

SECTIUNE A-A/ A-A SECTION
Sc. 1:20

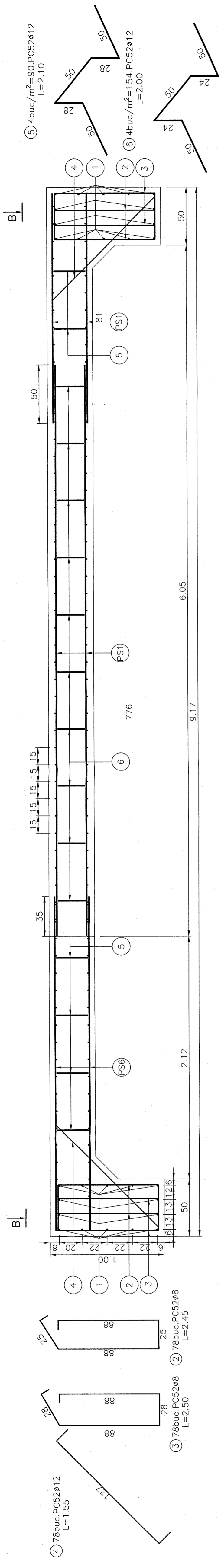

CONDITII DE CALITATE/QUALITY CONDITIONS
 -beton/concrete C30/37
 -clasa de expunere/exposure class-XC4-XF4
 -tipul de ciment/cement type-cem II α-s 42.5n
 -agregat/aggregate 0-32
 -tasare/slump s3
 -otel armatura/steel reinforcement PC 52
 -strat de acoperire pana la fata exteriora a primei bare/protection coating until the first exterior face of the first reinforcement 45mm
 -volum beton/volume of concrete~35.00mc
 -cofal/shutter ~18mp
 -suprapunerea pieselor va fi de minim 35cm/

Suprafata de panouri de plasa sudata utilizate/neutilizate
SC. 1:50

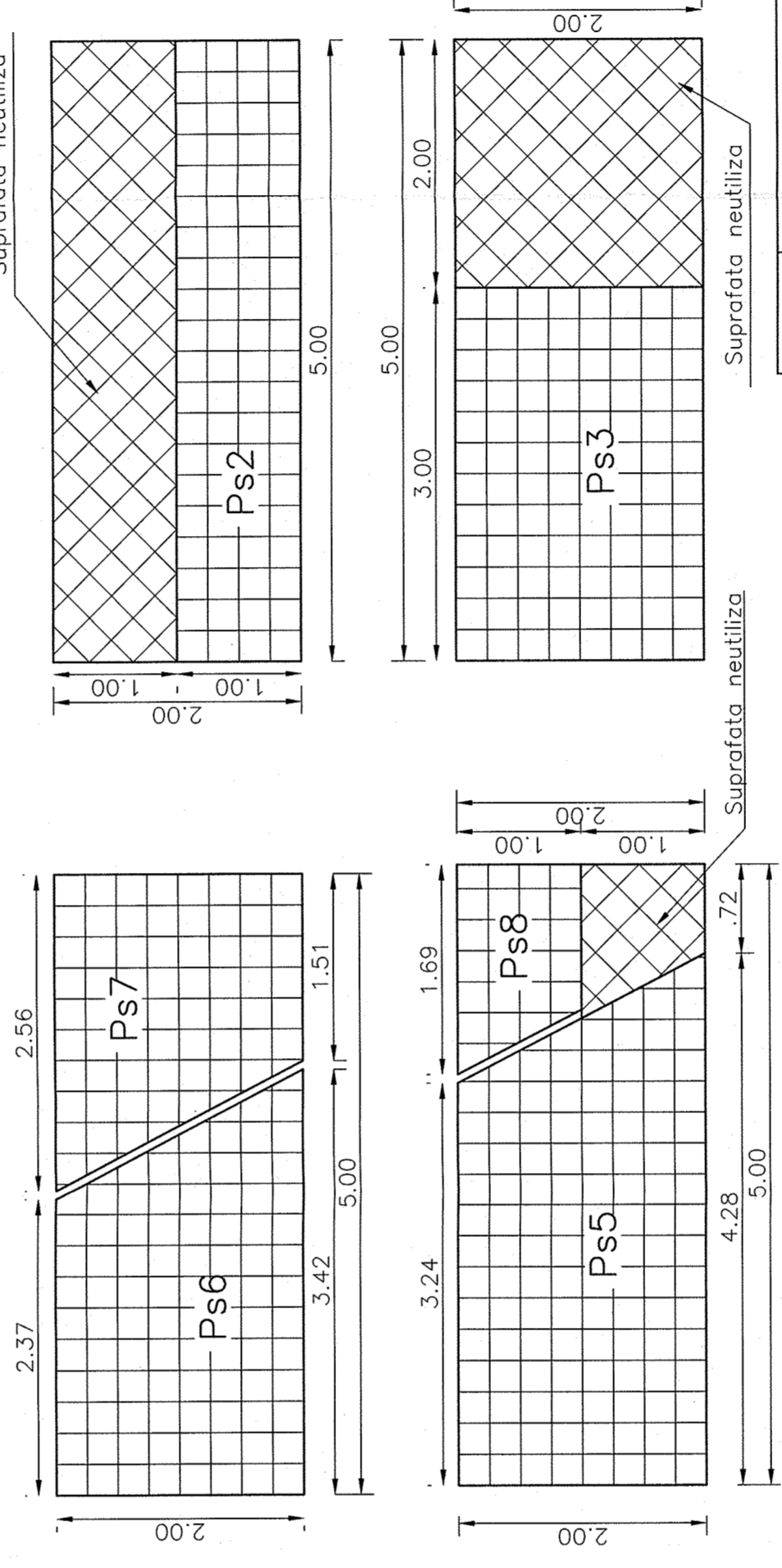

DETALIU PLASA SUDATA 150x150
SC. 1:50

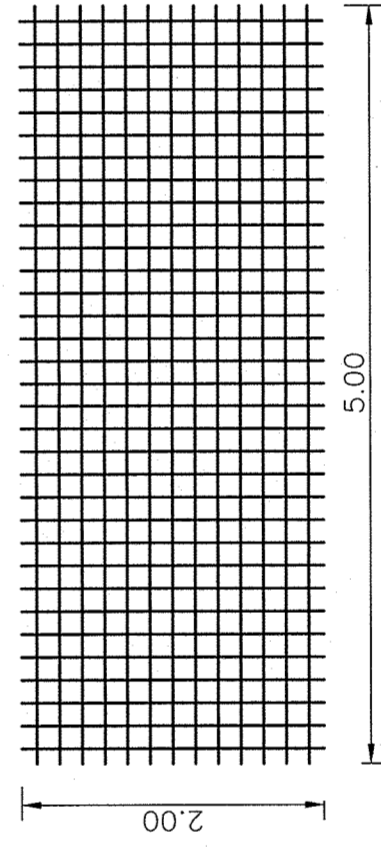

VEDERE PLANA B-B/ PLAN VIEW B-B
Sc. 1:50

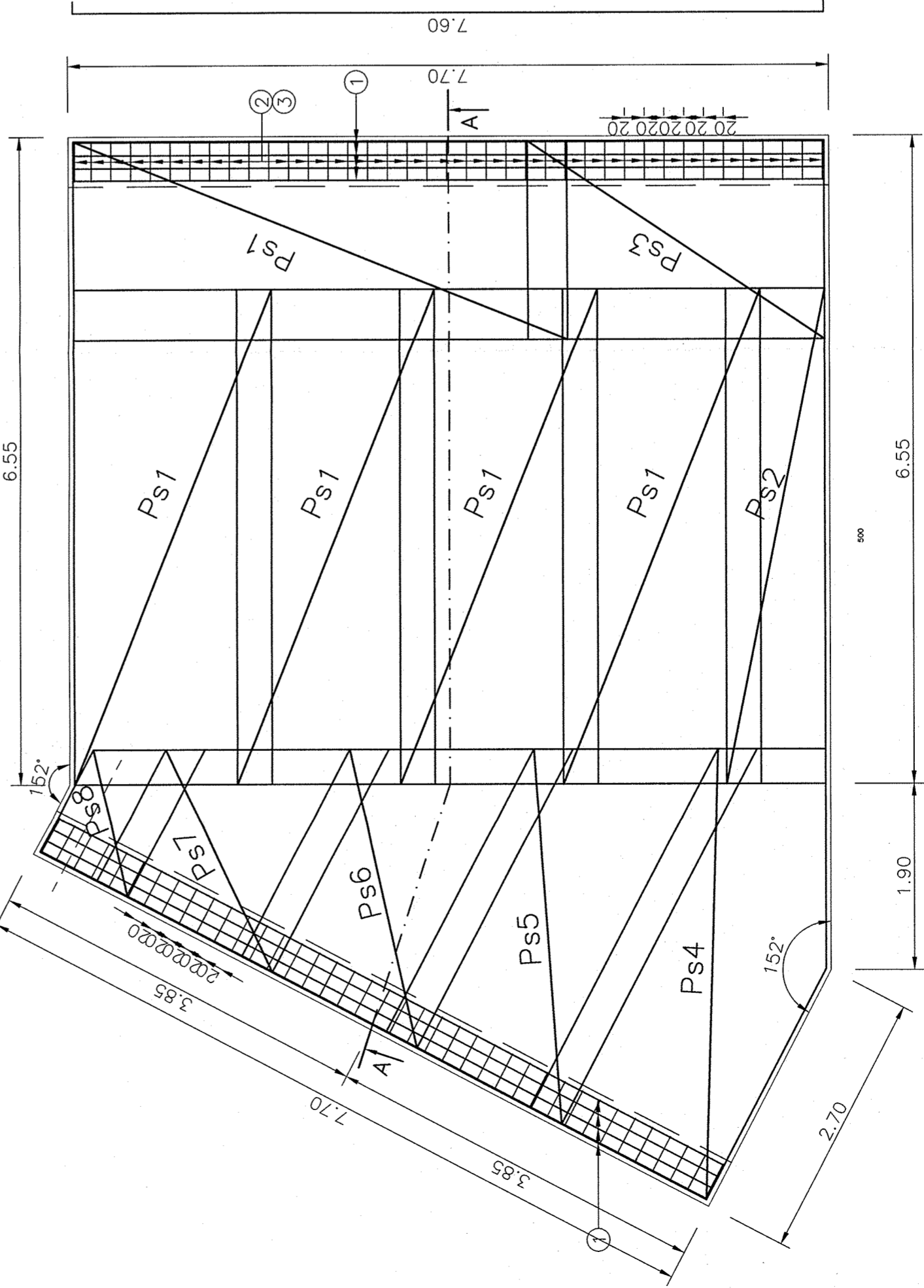

EXTRAS DE ARMATURA/REINFORCEMENT TABLE

Marca/Mark	φ [mm]	Lungime bare/ Bars length [m]	Numar bare/ Bars number [buc./ pcs.]	Lungimi pe diametre/ Length by diameter PC52
1	12	7.85	28	φ8
2	8	2.45	78	φ12
3	8	2.50	78	
4	12	1.55	78	
5	12	2.10	90	
6	12	2.00	154	
Lungimi pe diametre/ Lengths per diameter [m]				386.10
Masa pe metru/ Weight per meter [kg/m]				0.395
Masa pe diametru/ Weight per diameter [kg]				152.51
TOTAL [kg]				900

Pozitia / Position	Denumirea / Denomination	Numar plase/ Nets number [buc./ pcs.]	Masa buc. / Weight/ pct. [kg]	Masa totala/ Total weight [kg]
PS1	SR 438-3 - 150mm x 150mm- 5m x 2m, PC52 - 10 PC52 - 10 SR 438-4	5	98.03	490.15
PS2	SR 438-3 - 150mm x 150mm- 5m x 2m, PC52 - 10 PC52 - 10 SR 438-4	1	98.03	98.03
PS3	SR 438-3 - 150mm x 150mm- 5m x 2m, PC52 - 10 PC52 - 10 SR 438-4	1	98.03	98.03
PS4	SR 438-3 - 150mm x 150mm- 5m x 2m, PC52 - 10 PC52 - 10 SR 438-4	1	98.03	98.03
PS5,PS8	SR 438-3 - 150mm x 150mm- 5m x 2m, PC52 - 10 PC52 - 10 SR 438-4	1	98.03	98.03
PS6,PS7	SR 438-3 - 150mm x 150mm- 5m x 2m, PC52 - 10 PC52 - 10 SR 438-4	1	98.03	98.03
TOTAL [kg]				985

NOTA:
Lungimile armaturilor sunt date in axa lor.

BENEFICIAR/BENEFICIARY: ROMANIAN RAILWAY NATIONAL COMPANY
IMPLEMENTING AUTHORITY: ROMANIAN RAILWAY NATIONAL COMPANY
CONTRACTING AUTHORITY: AUTORITATEA CONTRACTANTA / CONTRACTING AUTHORITY
Ministerul Economiei si Finantelor
Ministry of Economy and Finance
Ministerul Transporturilor
Ministry of Transport

Contract / Contract: 33832007
Phase / Phase: P7H+DE
Project financed by: UNIUNEA EUROPEANA / EUROPEAN UNION
POS Transport
2007-2013

PORTOFOLIUL DE PROIECTE PHARE CES 2005 / PHARE CES 2006 PROJECTS PORTFOLIO
 LOT 1
 Asistenta tehnica pentru proiectarea, lucrul de teren, laboratoare, servicii ingineresti si studii de caldura
 Technical assistance for preparing rehabilitation works required by railway tunnels and bridges
 Sucursala RCF Railway district ASI, Linia de Railway line Damnest-Domolad
 Danubius
 Cod desen / Drawing Code: PD.265
 Nr. / No: 06

Intocmit / Designed: Ing. Leonard OLTEANU
Verificat / Checked: Ing. Ioan Dacin
Scara / Scale: 1:20
Data / Date: 05.2009

prointec
constr project